

# GMC CHEVROLET ABS REMOVAL SUV /PU

## For: 01 02 03 04 05 06 07

### Electronic Brake Control Module Replacement Removal Procedure

**NO NEED TO REMOVE THE PUMP ASSEMBLY, YOU MAY NEED TO LOOSEN THE BRACKET MOUNTING BOLTS FROM THE FRAME, DO NOT REMOVE BRACKET COMPLETELY FROM THE FRAME, PAY SPECIAL ATTENTION NOT TO CRIMP OR BEND BRAKE LINES.**

**Caution:** Refer to Battery Disconnect Caution in Service Precaution.

**Important:** After installation, calibrate the new electronic brake control module (EBCM) to the tire size that is appropriate to the vehicle.

1. Disconnect the negative battery cable.
2. Raise and suitably support the vehicle.

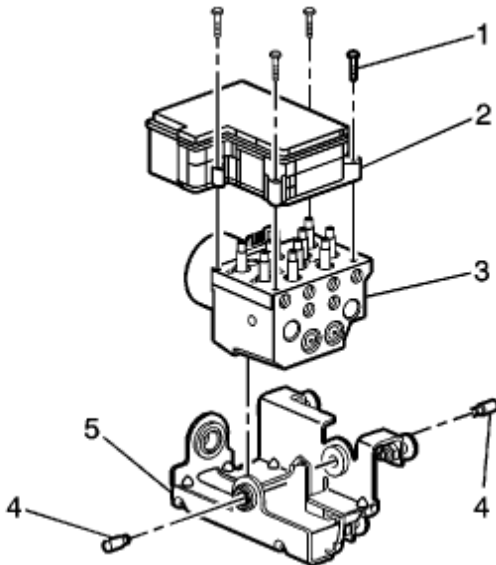

3. Important: The area around the electric hydraulic control unit (EHCU) MUST be free from loose dirt to prevent contamination of disassembled ABS components. Thoroughly wash all contaminants from around the EHCU.
4. Remove the mounting screws (1) that fasten the EBCM (2) to the brake pressure modulator valve (BPMV) (3).

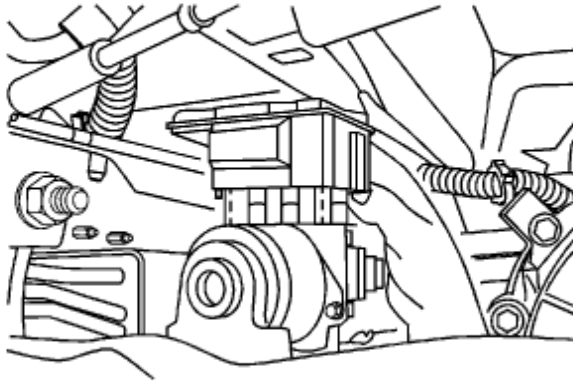

- 
5. Remove the EBCM from the BPMV. Removal may require a light amount of force.
  6. Remove the EBCM from the vehicle.
  7. Clean the BPMV to EBCM mounting surfaces with a clean cloth.

#### Installation Procedure

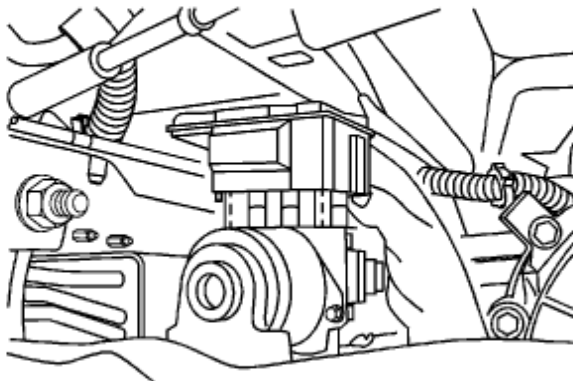

---

1. Important:

- Do not reuse the old mounting screws. Always install new mounting screws with the new EBCM.

- Do not use RTV or any other type of sealant on the EBCM gasket or mating surfaces.

Install the EBCM to the BPMV.

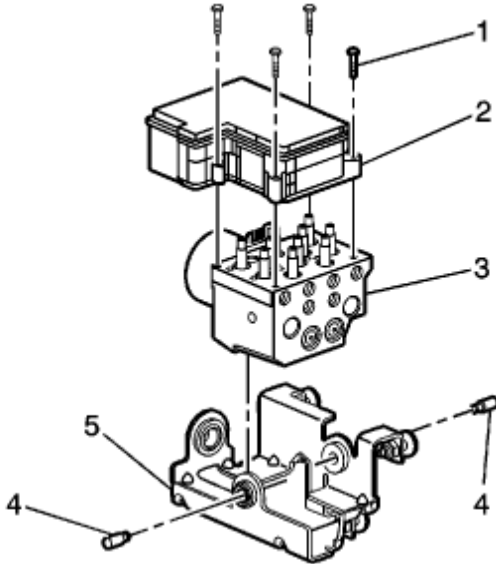

2. **Notice:** Refer to Fastener Notice in Service Precautions. Install the new EBCM screws (1).

- Tighten the screws to 5 Nm (39 inch lbs.) in an X-pattern.

3. Lower the vehicle.
4. Connect the negative battery cable.

**IF 60 amp fuse was removed, reinstall,**